

# TR30S Tuffrail Stainless Steel

## Industrial Handrail Specifications

### Top / Mid & Bottom Rails

For level, rake or stair applications

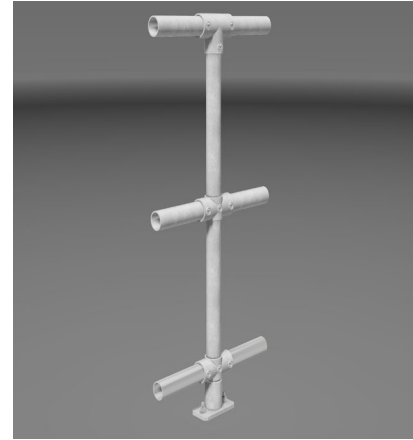

#### Key features

- › Modular flexibility
- › No-weld assembly
- › Superior corrosion protection
- › Flat pack delivery
- › Colour options available
- › Available ex-stock
- › BIM & CAD Support

#### Applications suited to

- › Water treatment facilities
  - › Harsh coastal environments
  - › Jetties and boardwalks
  - › Service platforms and mezzanines
  - › Warehouses and loading bays
  - › Retaining walls and culverts
  - › Roof service areas and fall edges
- Refer to applicable NZ Standards and Building Codes

#### Specification Summary

Supply and install the proprietary TR30S handrail system to substrate according to Moddex specifications, or by a Moddex accredited installer.

#### Technical Data

##### Material

<b>Stanchions &amp; rails</b>	316 Stainless Steel
<b>Clamp fittings</b>	Cast 316 Stainless Steel
<b>Clamp locking screws</b>	Stainless Steel (304)

##### Protective coating

<b>Optional</b>	Powder coating and paint specs*
-----------------	---------------------------------

\*The standard process for Powder Coated and Painted handrail products is as follows: black steel is used for fabrication. The steel is sand blasted and a zinc primer coating is applied. The powder coat / paint coat is then applied over the zinc primer creating a dual shield coating with a decorative finish.

#### Dimensions

Variable depending on building/application/ code

##### Stanchions

<b>Diameter</b>	48.3mm OD
<b>Nominal Thickness</b>	2.77 - 3.68 mm (loading dependent)

##### Rails

<b>Diameter</b>	48.3mm OD
<b>Nominal Thickness</b>	2.77mm

##### Clamp fittings

<b>Thickness</b>	5.0mm (approx)
<b>Locking screws</b>	M12 x 1.75 x 11mm - DEXX® Drive

#### Weight

Variable depending on building/application/ code

<b>Stanchion with clamps</b>	5.5 to 6.5kg
<b>Rail per metre</b>	3.11kg

#### Fixings

Stanchion attachment to

<b>Concrete</b>	M12, 316 stainless chemical anchor
<b>Structural steel</b>	M16 stainless high tensile bolt set
<b>Timber</b>	Stainless or galv coach screws

#### Compliance

Moddex TR30S handrails are designed and manufactured in accordance with New Zealand Standard NZS 1657 and relevant statutory WHS Codes of Practice/ Guidelines.

#### Testing

Testing and performance based on requirement of Standard AS/NZS 1170.1 Clause 3.6 Table 3.3. Static load testing has been performed and independent testing has been carried out to confirm the suitability of the Moddex system in maritime conditions.

#### Warranty

5 years from date of purchase subject to correct installation, use and maintenance in accordance with manufacturer's specifications and recommendations, unless otherwise negotiated at the time of purchase.

#### Inspection & Maintenance

Visual inspection for any damage or loose fixings must be done periodically and prior to use. No certified maintenance required. Basic wear and tear preventative maintenance is recommended, as per manufacturer's specifications and recommendations.

#### Basis of Design

When designed as per the Moddex PS1

1. Design Life: 50 years minimum
2. Building Occupancy: B, E
3. Loadings: AS/NZS 1170.1:2002 - Table 3.3  
AS 1657:2013 - CL6.1
4. Live Loadings: Line: 0.35kN/m  
Concentrated: 0.6 kN

## Technical Information

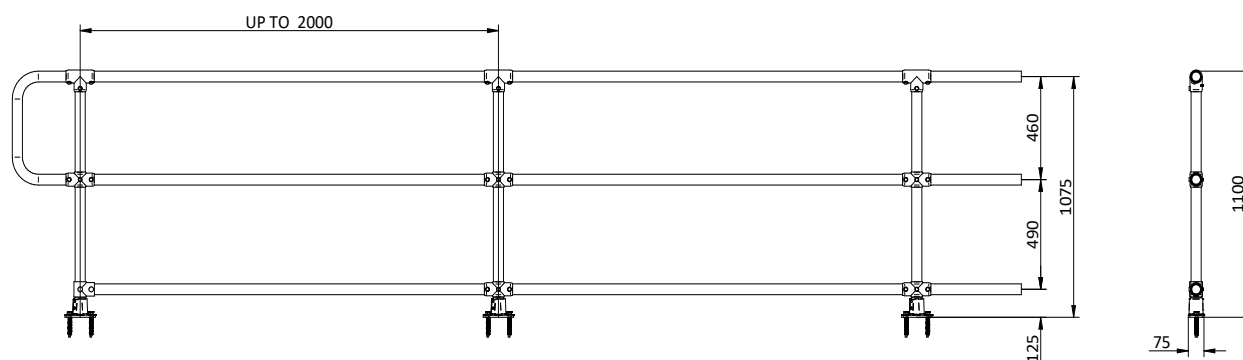

## Mount Dimensions

### FIXING TO CONCRETE

T2 - Top Mount (2 Fixings)

F2 - Face Mount (2 Fixings)

CD - Cored Mount

T4 - Top Mount (4 Fixings)

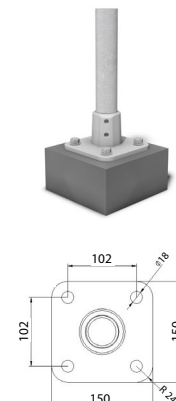
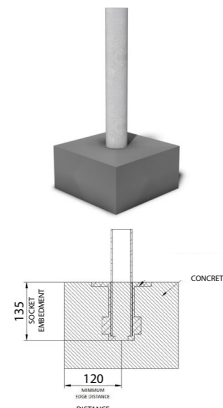
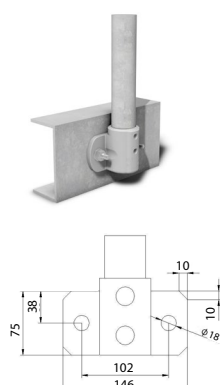
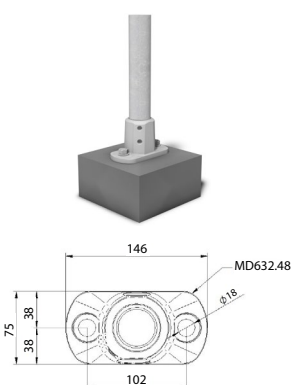

### FIXING TO STEEL

T2 - Top Mount (2 Fixings)

F2 - Face Mount (2 Fixings)

T4 - Top Mount (4 Fixings)

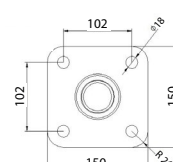
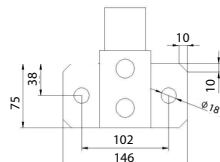
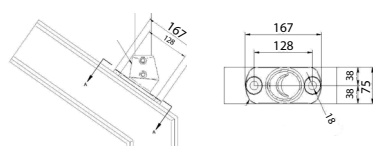

### FIXING TO TIMBER

T4 - Top Mount (4 Fixings)

F4 - Face Mount (4 Fixings)

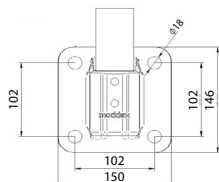
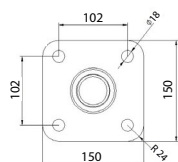

## Standard References

New Zealand Standard NZS 1657:1992

3.2 Protection at sides, ends, openings and edges

4.5 Guardrailing

4.6 Handrailing

**Important Note:** Failure to supply and/or install proprietary product in accordance with above Standards and codes and the Moddex PS1, voids complete system certification and/or warranty.

Designed and manufactured by Moddex. ©Moddex Group. All Rights Reserved.

For information or technical support please contact us

1800 663 339 (AU)

0800 663 339 (NZ)

[moddex.com](http://moddex.com)

## Technical Drawing MD582.0600 – Self Closing Gate

### MD582.0600

Post Spacing 600mm

Length 460mm

Height 460mm

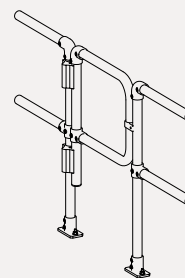
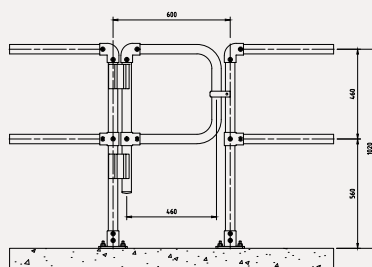

## Technical Drawing MD582.0900 – Self Closing Gate

### MD582.0900

Post Spacing 900mm

Length 760mm

Height 460mm

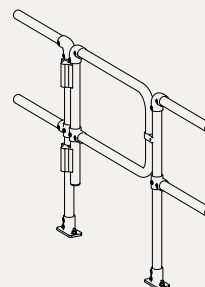
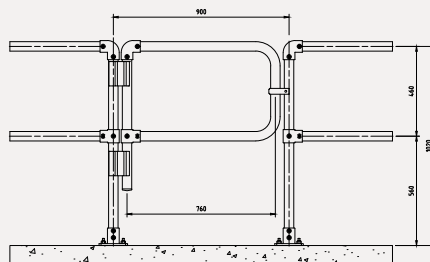

## Technical Drawing MD582.1200 – Self Closing Gate

### MD582.1200

Post Spacing 1200mm

Length 1060mm

Height 460mm

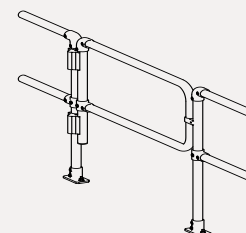
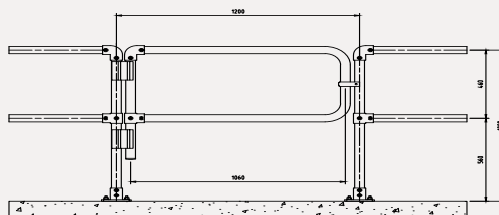

## Technical Drawing MD582.1500 – Self Closing Gate

### MD582.1500

Post Spacing 1500mm

Length 1360mm

Height 460mm

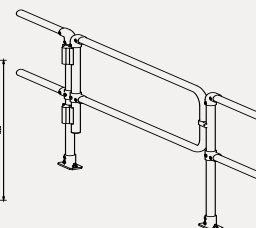
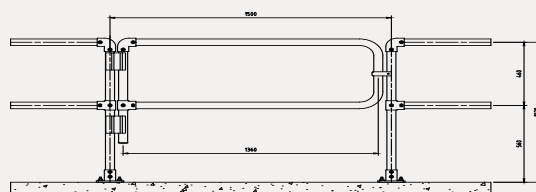

## Technical Drawing – 900mm Custom Gate with Toeboard

### MD582.0900 Custom

Post Spacing 900mm

Length 760mm

Height 1034mm

